

Technical Specification

REF: PST5

ISS: 1

Key Features

- Crystal Optic lens system
- 12 or 24 Volt Operation
- LED Long Life Reliability
- Popular 140mm Package Size
- Simple ¼" Spade connection

Technical Specification

Functions: Stop/Tail

Homologation: ECE

Voltage: 12v | 24v

Power Consumption: Stop (12v) 4.92w
(24v) 2.4w
Tail (12v) 2.92w
(24v) 1.2w

Connection: ¼" Spade

Fixing: M6 Bolt

IP Rating: IP67 Hermetically Sealed

Material: Lens – PMMA | Housing – ABS

Temperature Range: -40°C to +50°C

Part Numbers

SL800LED24v - Stop/Tail LED 24v

SL800LEDVV – Stop/Tail LED 9-33v

See Also

- 800 Combination
- 800 Reverse
- 800 Fog
- 800 DI

800 Series Stop/Tail



Overview

A popular 140mm LED Stop/Tail lamp, suitable for use with all 800 series signal lamps. Featuring ¼" spade terminals for easy connectivity.

The 800 Series includes a crystal optic lens system and can be used in conjunction with the CRL888 Modular Housing Unit.

Drawing

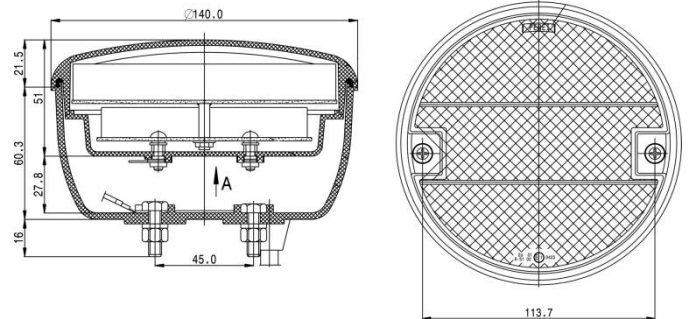

www.perei.co.uk | sales@perei.co.uk | +44 (0) 1842 812290

Perei Group Limited | Keystone Innovation Centre | Thetford | Norfolk | IP24 1JD | United Kingdom

Specifications herein are subject to change without notice

PEREI