

Technical Specification

REF: PR4

ISS: 2

Key Features

- Crystal Optic lens system
- 12 or 24 Volt Operation
- LED Long Life Reliability
- Popular 140mm Package Size
- Simple ¼" Spade connection

Technical Specification

Functions: Reverse

Homologation: ECE

Voltage: 12V | 24V

Power Consumption: Reverse (12V) 2.52W
(24V) 2.88W

Connection: ¼" Spade

Fixing: M6 Bolt

IP Rating: IP67 Hermetically Sealed

Material: Lens – PMMA | Housing – ABS

Temperature Range: -40°C to +50°C

Part Numbers

RV800LED24V – Reverse LED 24V

RV800LED12V – Reverse LED 12V

RV800LEDSS24V – Reverse LED 24V with SuperSeal

See Also

- 800 Combination
- 800 Stop/Tail
- 800 Fog
- 800 DI

800 Series Reverse



Overview

A popular 140mm LED Reverse lamp, suitable for use with all 800 series signal lamps. Featuring ¼" spade terminals for easy connectivity.

The 800 Series includes a crystal optic lens system and can be used in conjunction with the CRL888 Modular Housing Unit.

Drawing

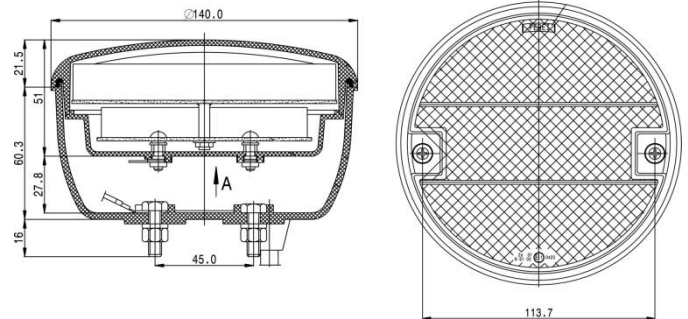

www.perei.co.uk | sales@perei.co.uk | +44 (0) 1842 812290

Perei Group Limited | 36 Wimbledon Avenue | Brandon | Suffolk | IP27 0NZ | United Kingdom

Specifications herein are subject to change without notice

